

WORLDWIDE SALES NETWORK



GH Wooden Fire Rated Door www.ghdoorframe.com

Dalian Golden House Door & Window Manufacture Co.,Ltd.

Address: Room301, No. 2-121, Shengli Road, Dalian City China.

Tel: 0086-411-84313423 0086-411-84345777

Fax: 0086-411-84359567

E-mail: lilyj@ghdoorframe.com

GH Hollow Metal Doors & Frames Industries Corp.USA Branch

Address: 15715 Heron Ave. La Mirada, CA. 90638 USA

Tel: 714-5628808

Fax: 714-5628998

E-mail: sales@ghdwi.com

GH Hollow Metal Doors & Frames Industries Corp. Canada Branch

Address: 111 1533 Broadway, Port Coquitlam, BC. V3C 6N9

Tel: 604-4756679

Fax: 604-4756678

E-mail: sales@ghdwi.com

GH Dalian Golden House
Door & Window Mfg Co.,Ltd

WOODEN FIRE RATED DOOR



INTRODUCTION

Our factory Dalian Golden House Door & Window Manufacture Co., Ltd is located in the beautiful and important port city Dalian, We are a professional door and door frame manufacturer.

It has nearly 30 years experience and the occupying area of company is 1, 200, 000 sq. ft., state of manufacturing facility includes manufacturing for nearly 1, 000, 000 sets of door and 1, 000, 000 sets of frame every year. Our company has strong R&D ability and hundreds of advanced equipments.

With a perfect market share and reputation in the domestic market, we set up a selling office and distribution center in Los Angeles and Vancouver, based on the huge demand in America and Canada, Golden House constantly strive to meet the demands of the doors by providing premium products to the customers. The Golden House commitment is to provide superior quality and service, at competitive pricing to our valued customers.



CERTIFICATIONS

Golden House wooden fire rated door tested door and frame according to UL10c; UL10b; NFPA252; UBC 7-2; ASTM E2074; CAN/ULC S104 by UL and Intertek.



WH Intertek 90mins wooden fire door certificate



WH Intertek 90mins steel frame certificate



FM 60mins steel-wooden fire door certificate



FM steel frame certificate



UL 20mins wooden fire door certificate



UL 20mins wooden frame certificate



ISO9001 certificate

SPECIFICATION

Door

Overall 1-3/4" minimum (44.5mm) with solid core in a high density mineral fire board. Door set tested and certified as fire rated from 20 mins to 90 mins. Suitable door set for apartments, offices, hotels, schools, hospitals and commercial buildings. Door surface are based on MDF, veneer, or laminate. All the constructions are usa popular standard.

Frame

Solid wood jamb (fire rated 20 mins) and metal jamb (fire rated 90 mins) available
Adjustable architrave available.
Adjustable metal jamb available.
Hot transfer wooden veneer painting on metal jamb available.
All USA standard anchor on jamb available.

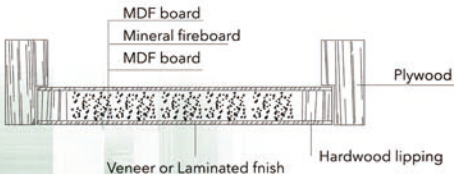

STRUCTURE AND FEATURE

20 minutes, 45 minutes, 60 minutes, and 90 minutes fire rated doors in any design.

Can be designed to match a non fire rated door at 1-3/4" thick.

Any size up to 8'0" height
Single and pair fire doors.

Paint grade or stain grade
Raised panel or flat panel fire doors.

Sound STC ratings fire doors
Machining for hinge, lock body, card reader,

rim exit devices, and etc.
Fire rated glass optional

20 minute through 90 minutes wood fire rated frame or steel fire rated frame (Paint grade or stained grade)

Mirrored glass and Lumicor architectural resin panels can be substituted for glass
Importantly, our doors remain at the standard 1 3/4" thickness even on 90-minute rating.



Finish

- Flush wood veneer, the structure is consist of MDF/plywood with veneer, stile and rail, solid wood edge, chipboard or mineral fireboard to be inside core, and it can be primer paint or stained painting finish.
- High pressure decorative laminate door
(Visible surface) Same as face material laminated (1.0mm) with edge-before-face construction. Optional edges are: unfinished or finished at factory, and painted at factory with a mill option hardwood edges for staining or painting.
Clearances: 1/8" top, 1/8" lock and hinge stiles. See NFPA-80 6.3.1.7.1, 2013 Edition. Bottom clearance is 3/4" max. (Bottom of the door to top finish floor) See NFPA-80 4.8.4.1, 2013 edition.

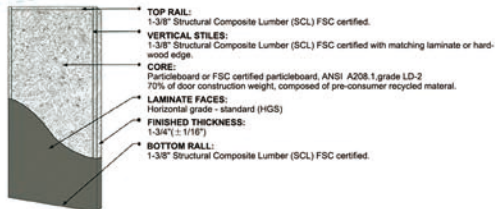

HOLLOW METAL FRAME & SOLID WOODEN FRAME

Hollow metal frame:

Frames are manufactured to accommodate any wall condition, including masonry frame and drywall frame type. A wide variety of frame anchors are available. Width up to and including 40", height up to and including 80"

- Available in knock down frame and welded frame.
- Material have cold roller or galvanized steel
- Steel thickness have 16ga, 14ga
- Fire rating from 45mins to 180mins
- Surface painting can match with wooden door color

Masonry/Stud Construction Frame



Drywall Frame

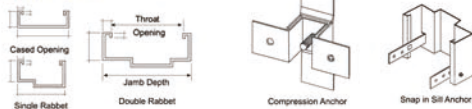

Solid wooden frame:

GH offers a complete line of non-fire rated and fire rated wooden frames with similar design appearance.

- Available in knock down frame and pre-hung frame.
- Material have fireproof plywood with wood veneer
- Min frame width: 100mm; max frame width: equal to wall thickness
- Fire rating up to 20mins with UL listed



MODEL PICTURE

Painting Finish



Veneer Finish



Laminated Finish



ACCESSORIES



Handle 001



Handle 002



Handle 003



Handle 004



Electronic Lock



Mortise Lock



Dead Lock



Knob Lock



Push And Pull Plate



Press Bar



Single Panic Bar



Double Panic Bar



Ball-bearing Hinge



Spring Hinge



Mounted Closer



Concealed Closer



Kick Plate

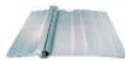

Threshold



Viewer

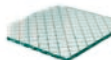

Wire Glass

DOOR AND FRAME HANDING CHART

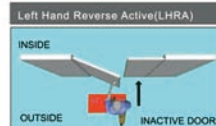
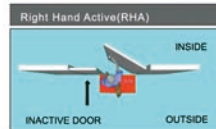
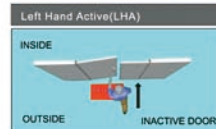
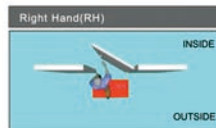
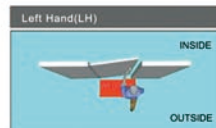

WOOD FIRE
Doors & Frames

PROJECT CASES

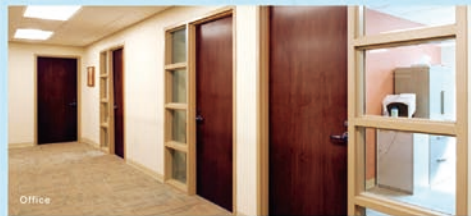
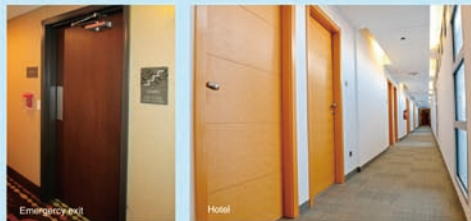

ACHIEVEMENTS

USA:

Watchtower Bible & Tract Society
The Max, Los Angeles, CA 90014
The Lansburgh-Washington D.C.
Avista Hotels

CANADA:

M&A Homes Group Ltd (The Myrida) -Saskatoon

GUAM:

Guam Mayflower High School;
Outpatient Specialty Clinic At
Guam Medical Plaza Building
Dusit Thani Hotel

AFGANISTAN:

Ancop Chamkani, Kabul,
Khwaja Jeer & Adraskan

KUWAIT:

Fire Service Directorate Building of Mishref

U.A.E.:

Bab Al Qasr Hotel
Saadiyat Beach Apartments

ASTANA KAZAKHSTAN:

Service Zone For Citizens
Of Asian Winter Games

KSA:

Zahran Business Center

MACAU:

Sands Macau
Wynn Macau
Galaxy Macau
MGM Macau



Start Here, Towards The World

WORLDWIDE SALES NETWORK

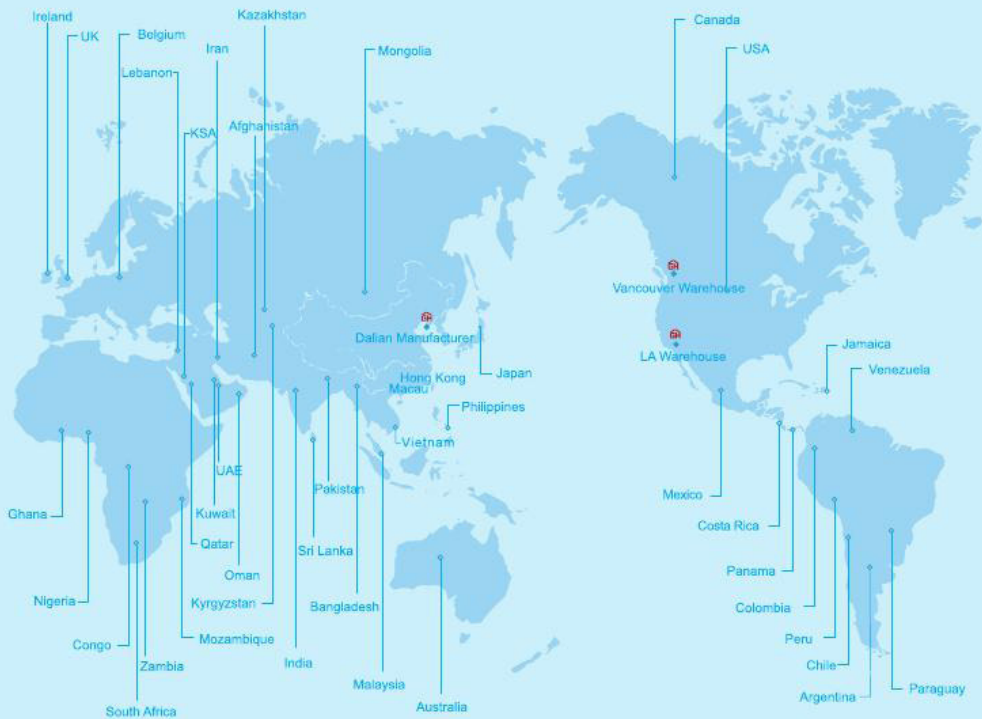

GH Hollow Metal
Doors & Frames www.ghdwi.com

Dalian Golden House Door & Window Manufacture Co.,Ltd.

Address: Room301, No. 2-121, Shengli Road, Dalian City China.
Tel: 0086-411-84313423
Fax: 0086-411-84359567
E-mail: sales@ghdwi.com

GH Hollow Metal Doors & Frames Industries Corp.USA Branch

Address: 15715 Heron Ave. La Mirada, CA. 90638 USA
Tel: 714-5628808
Fax: 714-5628898
E-mail:sales@ghdwi.com

GH Hollow Metal Doors & Frames Industries Corp. Canada Branch

Address: 1750 Coast Meridian RD, Port Coquitlam, BC
Tel: 604-4756679
Fax: 604-4756678
E-mail:sales@ghdwi.com

www.ghdwi.com

GH Hollow Metal
Doors & Frames

GH Hollow Metal Doors & Frames



INTRODUCTION

GH Hollow Metal Doors & Frames Industries Corp. is a professional manufacturer of a wide range of hollow metal doors, frames and wood doors for commercial and residential construction. GH Hollow Metal Doors & Frames Industries Corp. has more than 20 years experience and the occupying area of company is 1, 200,000 sq. ft., state of manufacturing facility includes manufacturing for nearly 1,000,000 sets of door and 1,000,000 sets of frame every year. GH products constantly strive to meet the demands of the doors by providing premium products to the customers. The GH commitment is to provide superior quality and efficient service, at competitive pricing to our valued customers.



Hollow Metal Doors & Frames

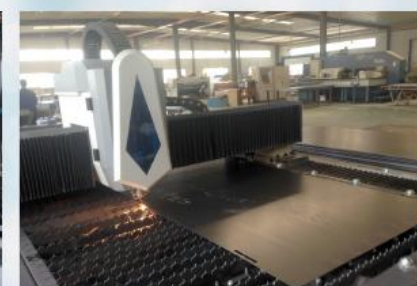

FLUSH STEEL COMMERCIAL DOORS



STEEL DOOR SKIN:

16GA (1.5mm), 18GA (1.1mm), 20GA (0.9mm)
A40 Galvanized Or Cold-rolled Steel Skins
Construction is 1-3/4" (45mm) Thickness

Hinge, closer, lock and strike plate reinforcements shall be provided.

Hinge reinforcement: 10GA (3.5mm)

Closer reinforcement: 12GA (2.5mm)

Lock reinforcement: 16GA (1.5mm)

Strike plate reinforcement: 16GA (1.5mm)

The top, bottom and side closures are fabricated from 16GA(1.5mm) thick channel shaped steel sections welded to the front and back door skins.

Flush top channel: 16GA(1.5mm)

Laser-welded side-seamed edge.

Widths up to and including 4'0"

Heights up to and including 8'0"

Available with polystyrene core or honeycomb core.

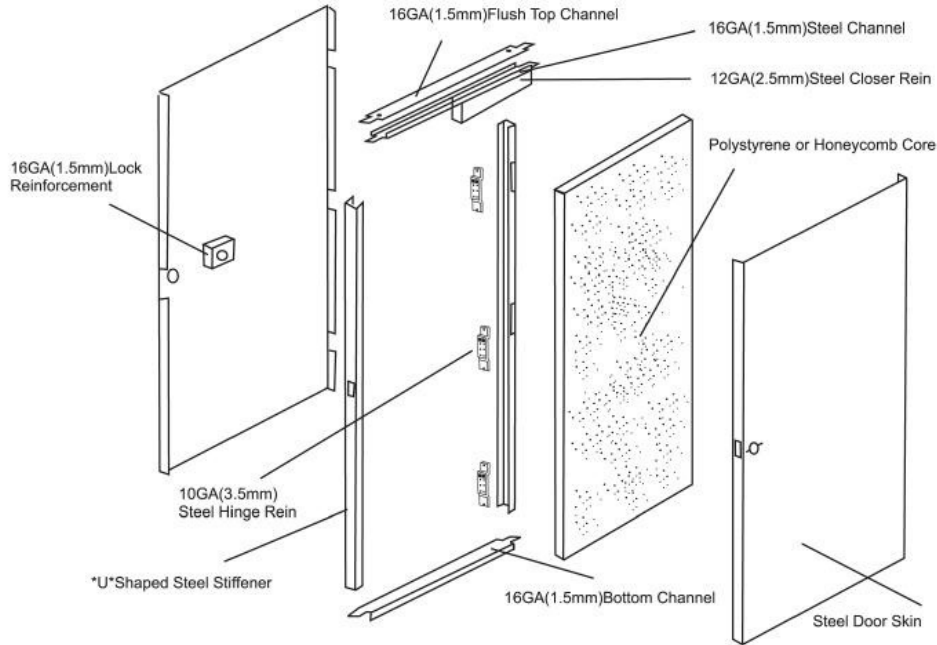

HINGE SHIM

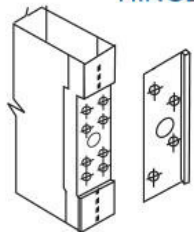

10GA(3.5mm) Steel Hinge Rein.
4-1/2" Hinge

CORE SERIES

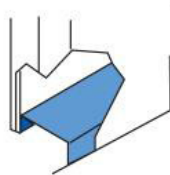

16GA(1.5mm)
bottom channel

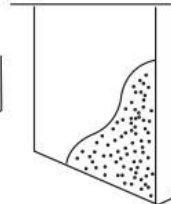

Polystyrene Core

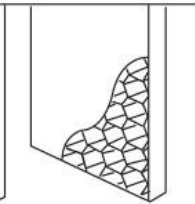

Honeycomb Core

HINGE AND LOCK PREP LAYOUT

FRAME

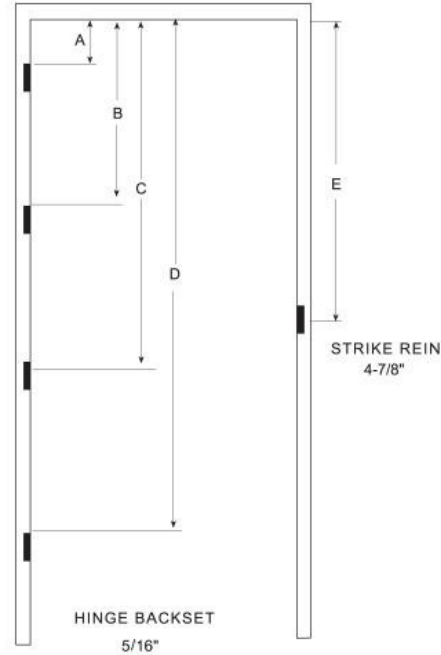

DOOR

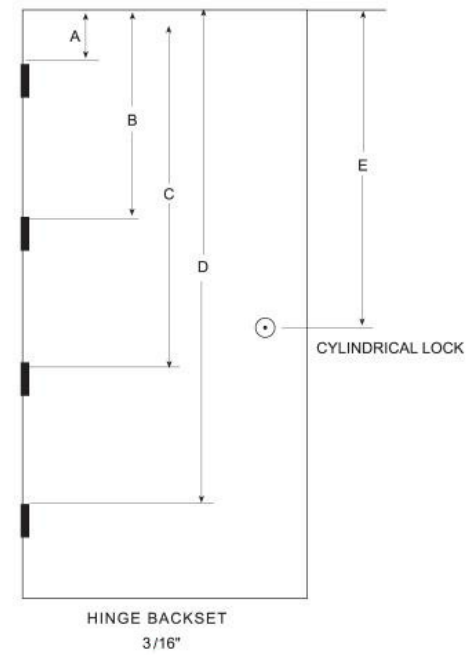

FRAME Other locations are available. We make to request.

SIZE	A	B	C	D	E
6'8"	7-1/2"	37-7/16"	67-3/8"		39-11/16"
7'0"	7-1/2"	39-7/16"	71-3/8"		43-11/16"
8'0"	7-1/2"	32-51/64"	58-3/32"	83-25/64"	55-11/16"

DOOR Other locations are available. We make to request.

SIZE	A	B	C	D	E
6'8"	7-3/8"	37-5/16"	67-1/4"		39-9/16"
7'0"	7-3/8"	39-5/16"	71-1/4"		43-9/16"
8'0"	7-3/8"	32-43/64"	57-31/32"	83-17/64"	55-9/16"

For mortise lock, dimension E is 3/8" greater.

MASONRY/STUD CONSTRUCTION FRAME

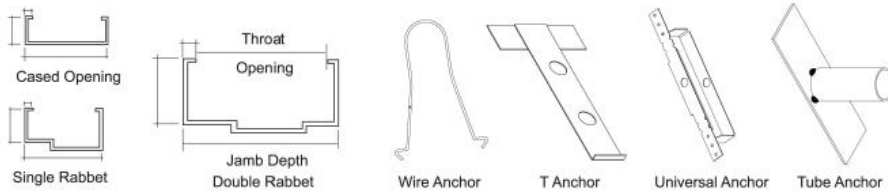

Jamb Depth	4-3/4"	5-3/4"	6-1/4"	6-3/4"	7-1/4"	7-3/4"	8-1/4"	8-3/4"	9-1/4"	10-1/4"
Throat Opening	3-3/4"	4-7/8"	5-1/4"	5-3/4"	6-1/4"	6-3/4"	7-1/4"	7-3/4"	8-1/4"	9-1/4"

DRYWALL FRAME

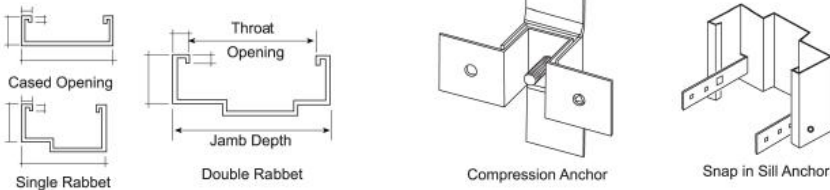

Jamb Depth	4-3/4"	5-7/8"	6-1/4"	6-5/8"	7-1/4"	7-3/4"	8-1/4"
Throat Opening	3-3/4"	4-7/8"	5-1/4"	5-5/8"	6-1/4"	6-3/4"	7-1/4"

ADJUSTABLE FRAME

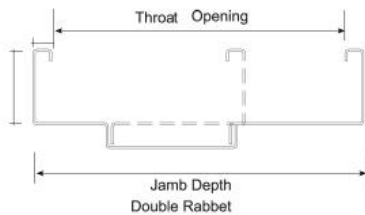

Jamb Depth	Mini Size 5-7/8"	Max Size 8-7/8"
Throat Opening	Mini Size 4-7/8"	Max Size 7-7/8"

WELDED OR KNOCK DOWN STEEL FRAMES

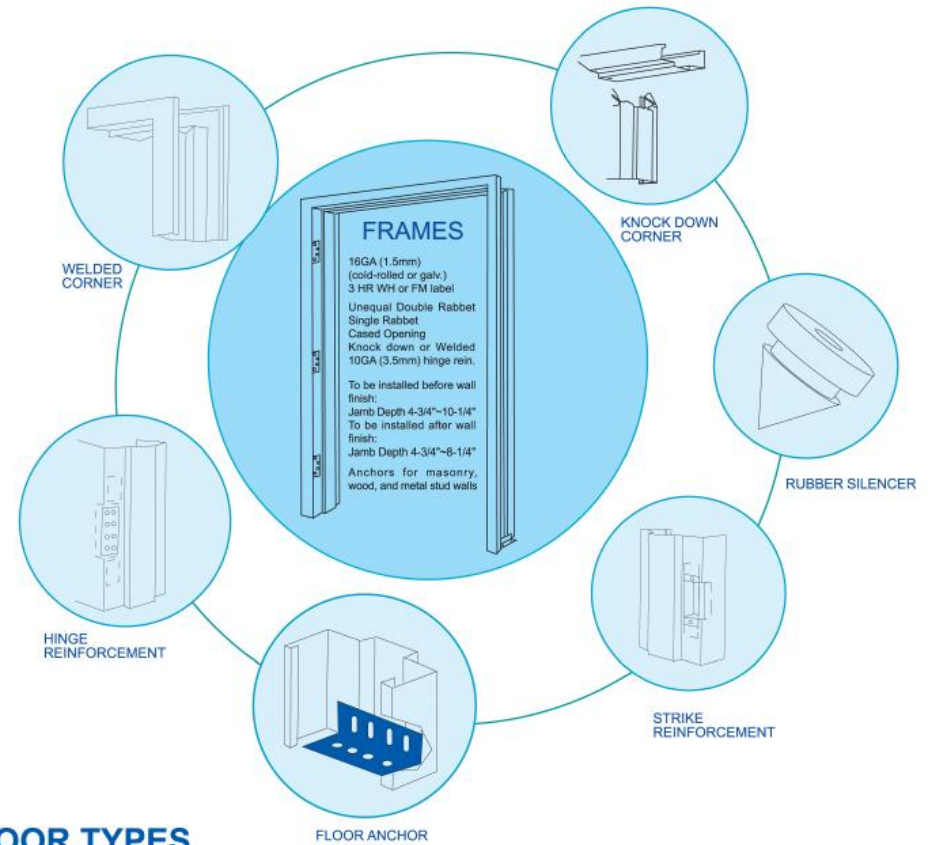

DOOR TYPES

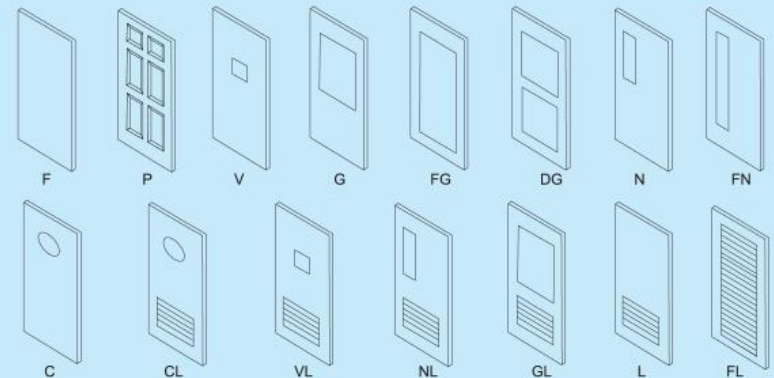

MASONRY/STUD CONSTRUCTION FRAME INSTALLATION

WOOD STUD CONSTRUCTION

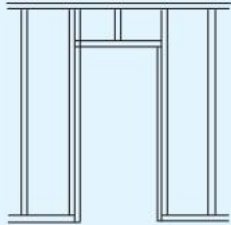

ROUGH STUD OPENING

Width=Nom. frame width + 4-3/8" min. to 4-3/4" max. (i.e. 3'0" =40-3/8" min. to 4-3/4" max.)

Height=Nom. frame height + 2-1/4" min. (i.e. 6'8"=82-1/4" min.)

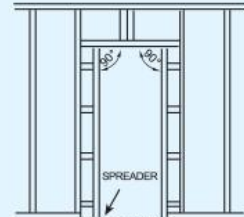
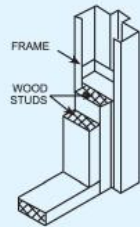

ROUGH STUD OPENING

- (1) Insert a minimum of three anchors per jamb. Can't anchors in frame throat and tap in with a hammer. Place frame in rough stud opening.
- (2) Bend anchor tabs around stud leaving desired clearance between frame return and stud.
- (3) Set spreader and level frame. Shim under jambs if necessary.
- (4) Square and nail top anchors to studs on ONE SIDE ONLY. Check plumb and square and continue to nail balance of anchors to studs.

MASONRY CONSTRUCTION

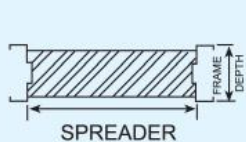

Typical wood spreader must be square and fabricated from lumber no less than 1" thick. Correct length is the door opening width between the jambs at the header. Cut clearance notches for frame stops. Spreader must be nearly as wide frame depth for proper installation.

i.e., Single door 3'0"=36"
Double door 6'0"=72"

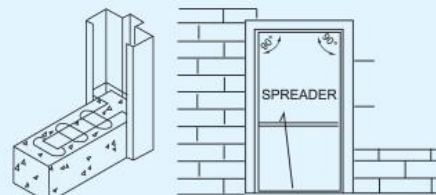

- (1) Set and plumb frame.
- (2) Install three anchors per jamb at quarter points as wall is laid up. Grout frame in the area of the anchors.
- (3) A second spreader is recommended at the mid point of the door opening to maintain the door opening dimension.
- (4) Continually check plumb and square as wall progresses.

DRYWALL FRAME INSTALLATION

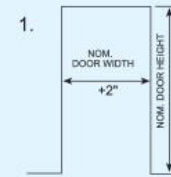

1. Prepare rough opening
Door nominal width + 2" Door nominal height + 1"
(i.e., 3070=38" width, 85" height.)

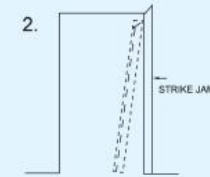

2. Install strike jamb by sliding over wall at top and engaging corner reinforcing into header. Pivot jamb into place.

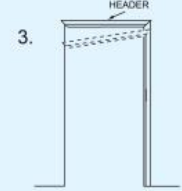

3. Install header into position approximately 1" from top and in the center of rough opening.

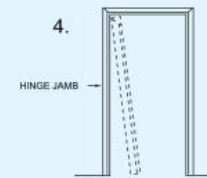

4. Repeat Step #2 with hinge jamb.

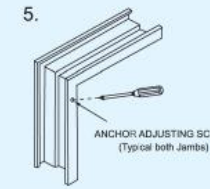

5. Turn adjusting screws in both jambs clockwise until anchor is resting against the wall.

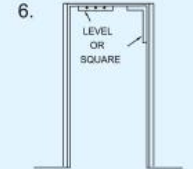

6. If feasible, hang door now and adjust frame on wall to allow proper door/frame clearance or plumb frame with carpenter square and/or level. (adjust header levelness by shimming under jambs.)

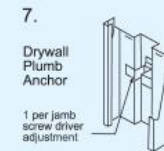

7. Drywall Plumb Anchor
1 per jamb screw driver adjustment

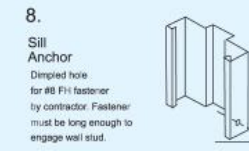

8. Sill Anchor
Dimpled hole for #8 FH fastener by contractor. Fastener must be long enough to engage wall stud.

Check door opening dimension at base of frame (same dimension as between jambs at header.)
Secure jambs with drywall screw(not furnished) through sill anchor at base of frame. Be sure to attach through both sill anchors on each side of jambs (4 places.)

DOOR AND FRAME HANDING CHART

<p>Left Hand(LH)</p> <p>INSIDE</p> <p>OUTSIDE</p>	<p>Right Hand(RH)</p> <p>INSIDE</p> <p>OUTSIDE</p>
<p>Left Hand Reverse(LHR)</p> <p>INSIDE</p> <p>OUTSIDE</p>	<p>Right Hand Reverse(RHR)</p> <p>INSIDE</p> <p>OUTSIDE</p>
<p>Left Hand Active(LHA)</p> <p>INSIDE</p> <p>OUTSIDE</p> <p>INACTIVE DOOR</p>	<p>Right Hand Active(RHA)</p> <p>INSIDE</p> <p>OUTSIDE</p> <p>INACTIVE DOOR</p>
<p>Left Hand Reverse Active(LHRA)</p> <p>INSIDE</p> <p>OUTSIDE</p> <p>INACTIVE DOOR</p>	<p>Right Hand Reverse Active(RHRA)</p> <p>INSIDE</p> <p>OUTSIDE</p> <p>INACTIVE DOOR</p>

FIRE DOOR REQUIREMENTS

Opening	Label Classification	Location In Building		Glass
	3 HOUR RATING	3 hour rated opening (Class A). Openings are in walls separating buildings or dividing a single building into fire areas. Doors for these openings require a fire protection rating of 3 hours.		None
	1-1/2 HOUR RATING	1-1/2 hour rated opening (Class B). Openings are in enclosures of vertical communication through buildings. These could be stairwells or elevator shafts. While not a means of vertical communication, boiler room doors are generally categorized as Class "B" openings. Door for these areas require a fire protection rating of 1-1/2 hours, and glass areas may not exceed 100 square inches per individual door leaf except as noted below.		100 Sq. In. per door Leaf
	3/4 HOUR RATING	3/4 hour rated opening (Class C). Openings are in corridors and room partitions. Doors for these areas require a fire protection rating of 3/4 hour, and the glass area cannot exceed 1296 square inches per light with no dimension exceeding 54 inches except as noted below.		1296 Sq. 1n.per Light
	1-1/2 HOUR RATING	1-1/2 hour rated opening (Class D). Openings are in exterior walls which are subject to severe fire exposure from the outside of the building. Doors for these areas require a fire protection rating of 1-1/2 hours.		None
	3/4 HOUR RATING	3/4 hour rated opening (Class E). Openings are in exterior walls which are subject to moderate or light fire exposure from the outside of the building. A typical example would be a door leading to an exterior fire escape. Doors for these openings require a fire protection rating of 3/4 hour with glass areas not exceeding 1296 square inches per light with no dimension exceeding 54 inches.		1296 Sq. In.per Light
	20 MINUTE	20 minute fire rated door frame assemblies are normally found in interior partitions and are intended for installation with 20 minutes fire rated doors of the single or swing in pairs.		1296 Sq. 1n.per Light

CERTIFICATIONS

Intertek WH 3HR approval for single steel doors and frames.
 Intertek WH 1.5HR certificate for double steel doors and frames
 Intertek WH 1.5HR approval for wood doors.



FM Approval 3HR certificate for double steel doors and frames
 FM Approval 1.5HR certificate for single steel doors and frames
 FM Approval 1HR certificate for steel-wooden doors and frames



Hollow Metal Doors & Frames

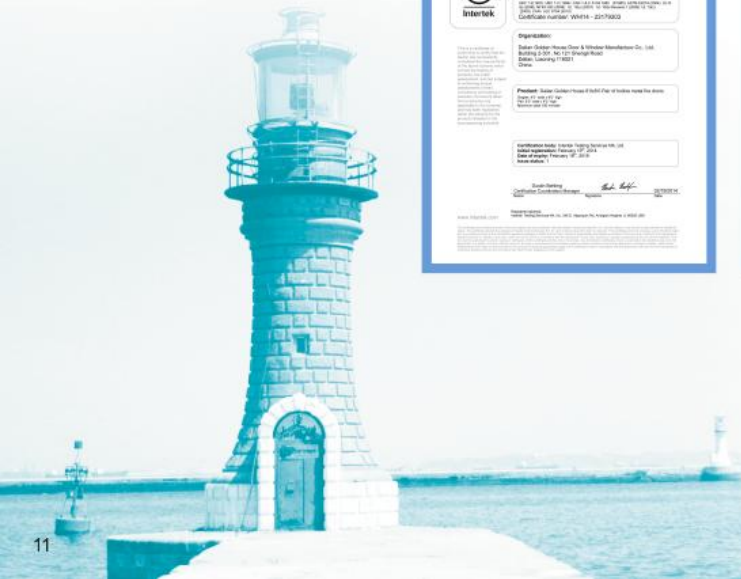

FIRE RATED DOOR GALLERY



Our Metal Doors



The steel used in our metal doors is widely recyclable and is frequently sourced from post-consumer sources such as the auto industry. Steel is the most commonly recycled material in the United States. more than 50 percent of the steel has been recycled through the steel manufacturing process. Impressive history of recycling, a wide variety of collection programs exist to recycle steel products.

HARDWARE



Closer



Mortise Lock



Cylinder Lock



Hinge

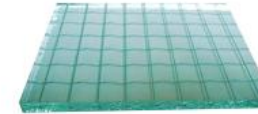

Wire Glass



Panic Bar

